

GENERAL AND PAVING NOTES

- ALL CONSTRUCTION ACTIVITY AND TEST METHODS SHALL BE IN CONFORMANCE WITH P.A.G. TUCSON STANDARD SPECIFICATIONS AND DETAILS FOR PUBLIC IMPROVEMENTS (P.A.G. S.S.P.I.), 2015 EDITION.
- DRAINAGE PIPE SHALL CONFORM TO P.A.G. S.S.P.I. SECTION 5010R AS DIRECTED BY THE ENGINEER.
- PIPE BEDDING SHALL CONFORM TO P.A.G. STANDARD DETAIL 108.
- AGGREGATE BASE COURSE SHALL CONFORM TO P.A.G. S.S.P.I. SECTION 303.
- ASPHALTIC CONCRETE SHALL CONFORM TO P.A.G. S.S.P.I. SECTION 406 (MIX #2).
- ALL CONCRETE SHALL CONFORM TO P.A.G. S.S.P.I. SECTION 1006, CLASS S, 3,000 PSI COMPRESSIVE STRENGTH AT 28 DAYS, UNLESS OTHERWISE SPECIFIED.
- PAVEMENT SECTION DESIGN DOCUMENTATION, ARE IN ACCORDANCE TO THE APPROVED GEOTECHNICAL REPORT.
- ALL DRAINAGE INFRASTRUCTURES, INDICATED ON THE PLANS, ARE IN ACCORDANCE TO THE APPROVED DRAINAGE REPORT APPROVED BY DEVELOPMENT SERVICES DEPARTMENT.
- ALL CHANGES TO THESE PLANS MUST BE CLEARED BY THE CITY OF TUCSON CITY ENGINEER'S PERMITS AND CODES SECTION, PRIOR TO CONSTRUCTION.
- THE CITY SHALL NOT BE HELD LIABLE FOR ANY ERRORS AND/OR OMISSIONS ON THESE PLANS. ITEMS NOT MEETING CITY STANDARDS SHALL BE REPAIRED/REPLACED AT NO COST TO THE CITY.
- THE ENGINEER OF RECORD SHALL SUBMIT TO THE CITY FOR REVIEW ANY CHANGES TO THE APPROVED PLANS PRIOR TO CONSTRUCTION. ADDITIONALLY, THE ENGINEER OF RECORD SHALL CERTIFY ALL CHANGES MEETING ALL APPLICABLE STANDARDS, CODES, AND ORDINANCES.
- AN EXCAVATION PERMIT SHALL BE OBTAINED FROM THE CITY OF TUCSON TRANSPORTATION DEPARTMENT PRIOR TO ANY WORK WITHIN THE PUBLIC RIGHT-OF-WAY.
- A PRE-CONSTRUCTION FIELD MEETING SHALL BE CONDUCTED WITH THE CITY OF TUCSON TRANSPORTATION INSPECTOR PRIOR TO ANY WORK WITHIN THE PUBLIC RIGHT-OF-WAY.
- THE EXTENT AND TYPE OF SURFACE TREATMENTS/REPAIRS INDICATED ON THE PLANS MAY NOT BE ALL INCLUSIVE OF THE WORK THAT IS NEEDED. ADDITIONAL REPAIRS, PAVING, OR REPLACEMENT MAY BE NEEDED DEPENDING ON FIELD CONDITIONS.
- THE CONTRACTOR SHALL CONTACT AND/OR COORDINATE ANY WORK WITH COT STREETS & TRAFFIC MAINTENANCE DIVISION, MEDIAN ISLAND MAINTENANCE SECTION (791-5279, EXT. 234) PRIOR TO DISTURBING ANY COT/DOT LANDSCAPING OR IRRIGATION SYSTEMS. ADDITIONALLY, THE CONTRACTOR SHALL REPAIR OR REPLACE ANY DISTURBED COT/DOT LANDSCAPING OR IRRIGATION SYSTEMS, INCLUDING REPLACEMENT OF ANY DAMAGED PLANTS. CONTACT GARY WITWER @ 400-2645 FOR INSPECTION AND PERMITS FOR LANDSCAPING. FOR IRRIGATION REMOVAL/REPLACEMENT CONTACT PAUL ROSENBOOM @ 237-7386.
- THE PIA INSPECTOR SHALL VERIFY THAT THE "SAW-CUT" LINE IS LOCATED WITHIN COMPETENT PAVEMENT. ADJUSTMENTS TO THE PLAN SHALL BE DOCUMENTED AND AS-BUILT; A ONE FOOT MINIMUM SHALL BE PROVIDED."
- CONTRACTOR SHALL OBTAIN ALL OTHER PERMITS AS REQUIRED BY LOCAL, STATE AND FEDERAL REQUIREMENTS.
- A COPY OF THE APPROVED PLAN SHALL BE KEPT IN AN EASILY ACCESSIBLE LOCATION ON THE SITE AT ALL TIMES DURING CONSTRUCTION.
- SIGNAGE AND STRIPING SHOULD BE COORDINATED WITH TRAFFIC ENGINEERING AND INSTALLED AT NO EXPENSE TO THE PUBLIC. CALL TRAFFIC ENGINEERING AT 791-4259 PRIOR TO THE INSTALLATION OR REMOVAL OF STRIPING AND SIGNAGE.
- UPON COMMENCEMENT OF WORK, TRAFFIC CONTROL DEVICES SHALL BE POSTED AND MAINTAINED BY THE CONTRACTOR UNTIL SUCH TIME AS THE WORK IS COMPLETED. ALL WARNING SIGNS BARRICADES ETC. SHALL BE IN ACCORDANCE WITH THE MANUAL ON UNIFORM TRAFFIC CONTROL DEVICES ADOPTED BY THE STATE OF ARIZONA PURSUANT TO A.R.S. 28-650. CONTACT TRAFFIC ENGINEERING, 791-4259, 48-HOURS PRIOR TO PLACING OR REMOVING ANY SAID TRAFFIC CONTROL DEVICES.
- TDOT IS NOT RESPONSIBLE FOR THE CONCRETE SLAB LOCATED IN THE PUBLIC ALLEY BEHIND THE BUILDING. THE OWNER SHALL BE RESPONSIBLE FOR MAINTENANCE OF THE CONCRETE SLAB.
- CONTRACTOR SHALL CALL BLUE STAKE AS MANDATED BY THE ARIZONA REVISED STATUTES AT 1-800-782-5348 BEFORE ANY CONSTRUCTION BEGINS TO VERIFY LOCATION OF EXISTING UTILITIES SHOWN OR NOT SHOWN. EXISTING UTILITY LOCATIONS SHOWN HEREON ARE ONLY APPROXIMATE. IT IS THE CONTRACTOR'S RESPONSIBILITY TO CONFIRM HORIZONTAL AND VERTICAL LOCATION OF ALL UTILITIES WITHOUT DAMAGING SAME. DAMAGED UTILITIES SHALL BE REPAIRED AT NO EXPENSE TO THE CITY.
- THE CONTRACTOR SHALL CONTACT AND/OR COORDINATE ANY WORK WITH COT STREETS & TRAFFIC MAINTENANCE DIVISION, ELECTRIC SHOP 791-3154 PRIOR TO RELOCATION OR PLACEMENT OF ANY STREET LIGHTING OR TRAFFIC FACILITIES. CONTACT ERNIE ENCINAS AT 791-3154 FOR STREET LIGHTING/TRAFFIC SIGNAL PLAN REVIEW.
- THE CONTRACTOR SHALL COMPLY WITH ALL APPLICABLE OCCUPATIONAL SAFETY AND HEALTH ADMINISTRATION REGULATIONS.
- A SOILS ENGINEER SHALL CONDUCT QUALITY CONTROL MATERIAL AND INSPECTION TESTING IN ACCORDANCE TO CITY STANDARDS AND SPECIFICATIONS AT NO COST TO THE CITY.
- ALL UTILITY RELOCATIONS REQUIRED SHALL BE BILLABLE TO THE CUSTOMER.
- DURING CONSTRUCTION, THE DEVELOPER/CONTRACTOR SHALL BE REQUIRED TO PERFORM DAILY CLEAN UP, DUST CONTROL, AND MAINTENANCE OF ALL ADJACENT (OFF SITE) ROADWAYS USED DURING THE COURSE OF THIS PROJECT.
- A GEOTECHNICAL ENGINEERING INVESTIGATION, INCLUDING RECOMMENDATIONS FOR GRADING PROCEDURES, HAS BEEN PREPARED FOR THIS PROJECT BY SPEEDIE AND ASSOCIATES; PROJECT NUMBER 170039ST, DATED JANUARY 31, 2017. EARTHWORK AND PAVING SHALL CONFORM TO THE RECOMMENDATIONS CONTAINED IN SAID REPORT.
- BOUNDARY, SURVEY DATA, AND EXISTING IMPROVEMENTS SHOWN ON PLAN ARE PER SURVEY PREPARED BY PUTT LAND SURVEYING, INC., 4817 E. 5TH ST., TUCSON, AZ AND SEALED BY PAUL COTE, RLS NO. 50761, DATED 01/19/2017. GRENIER ENGINEERING, INC. ASSUMES SAID BOUNDARY, TOPO AND OTHER INFORMATION SHOWN ON SAID PLAN TO BE CORRECT AND ACCURATE FOR DESIGN, DEVELOPMENT AND ALL OTHER PURPOSES, HAS RELIED THEREON AND ACCEPTS NO RESPONSIBILITY FOR ANY DISCREPANCIES BETWEEN THE PLAN BEARINGS, DISTANCES AND QUANTITIES CALCULATED FROM THIS TOPO AND THE FINAL CONSTRUCTION QUANTITIES OR DISTANCES OR BEARINGS, INCLUDING, WITHOUT LIMITATION, ANY OWNER/CONTRACTOR OR PAYMENT DISPUTES CREATED AS A RESULT OF THESE DISCREPANCIES.

GENERAL SEWER NOTES

- ALL DESIGN STANDARDS, MATERIALS AND WORKMANSHIP FOR PUBLIC SANITARY SEWERS SHALL BE IN ACCORDANCE WITH THE PIMA COUNTY REGIONAL WASTEWATER RECLAMATION DEPARTMENT (PCRWRD) ENGINEERING DESIGN STANDARDS 2016 (EDS 2016) AND THE STANDARD SPECIFICATIONS AND DETAILS FOR CONSTRUCTION 2016 (SSDC 2016). SAID DOCUMENTS ARE AVAILABLE THROUGH THE PCRWRD WEBSITE (WWW.PIMA.GOV/WASTEWATERRECLAMATION).
- THE CONTRACTOR SHALL CONTACT "ARIZONA 811" (DIAL 811 OR 1-800-782-5348) A MINIMUM OF TWO (2) BUSINESS DAYS PRIOR TO COMMENCING CONSTRUCTION ACTIVITIES. THE CONTRACTOR SHALL KEEP ALL UNDERGROUND FACILITY LOCATION REQUESTS UP-TO-DATE AND COMPLY WITH ARIZONA REVISED STATUTES (A.R.S.), TITLE 40, CHAPTER 1, ARTICLE 6.3, SECTION 40-360.22. CONCERNS REGARDING THE ACCURACY BETWEEN THE UNDERGROUND FACILITY MARKINGS AND THE PROJECT PLANS SHALL BE IMMEDIATELY REPORTED TO THE DESIGN ENGINEER.
- CONTRACTOR SHALL MAINTAIN ACCESS TO ALL SANITARY SEWER MANHOLES AT ALL TIMES.
- ANY HOUSE CONNECTION SEWER (HCS) OR BUSINESS CONNECTION SEWER (BCS) LINES ENCOUNTERED DURING CONSTRUCTION SHALL BE PROTECTED, REPAIRED, OR REROUTED, AS THE SITUATION DICTATES, PER PCRWRD SSDC 2016 DETAIL NO. RWRD 400 AND AT NO EXPENSE TO THE PROPERTY OWNER OR PCRWRD. HCS AND BCS LINES ARE NOT OWNED OR MAINTAINED BY PCRWRD. PRIVATE CONNECTION SEWERS CONSTRUCTED PRIOR TO JANUARY 2006 ARE NOT REQUIRED TO BE LOCATED AND MARKED.
- IMMEDIATELY REPORT ANY OF THE FOLLOWING TO THE PCRWRD OPERATIONS CONTROL CENTER (OCC) AT (520) 724-6500: ANY RELEASE OF SEWAGE, ANY DAMAGE TO THE PUBLIC SANITARY SEWER SYSTEM, OR THE DROPPING OF DEBRIS INTO A PUBLIC SANITARY SEWER MANHOLE. A PCRWRD REPRESENTATIVE WILL BE DISPATCHED TO THE SITE. THE CONTRACTOR SHALL TAKE IMMEDIATE ACTION TO CONTAIN A SANITARY SEWAGE OVERFLOW (SSO). THE CONTRACTOR SHALL BE RESPONSIBLE FOR ALL COSTS TO REPAIR THE SYSTEM, MITIGATE THE RELEASE OF SEWAGE, DISINFECT THE RELEASE AREAS, AND ANY REGULATORY PENALTIES LEVIED ON PCRWRD FOR SEWAGE ENTERING A NATURAL DRAINAGE WAY OR STORM WATER DRAINAGE SYSTEM. THE CONTRACTOR SHALL REPAIR ALL DAMAGE AS DIRECTED AND APPROVED BY THE PCRWRD FIELD REPRESENTATIVE.
- MODIFICATION TO OR ADJUSTMENT OF EXISTING PIMA COUNTY SEWER FACILITIES SHALL NOT COMMENCE UNTIL: (A) THE CONTRACTOR HAS OBTAINED A PCRWRD PUBLIC SEWER CONSTRUCTION PERMIT (CONTACT THE PCRWRD PERMITS SECTION AT (520) 724-6649 FOR PERMIT APPLICATION REQUIREMENTS); (B) THE CONTRACTOR'S FLOW MANAGEMENT PLAN HAS BEEN SUBMITTED THIRTY (30) CALENDAR DAYS PRIOR TO THE PRE-CONSTRUCTION MEETING AND APPROVED BY PCRWRD FIELD ENGINEERING; AND (C) A PRE-CONSTRUCTION MEETING WITH THE ASSIGNED PIMA COUNTY PROJECT FIELD INSPECTOR IS SCHEDULED AT LEAST THREE (3) FULL BUSINESS DAYS PRIOR TO COMMENCING WITH SEWER CONSTRUCTION.
- THE CONTRACTOR SHALL ADJUST OR RECONSTRUCT ALL SANITARY SEWER MANHOLES TO FINISHED GRADE. ALL FRAMES AND COVER ADJUSTMENTS SHALL BE IN ACCORDANCE WITH PCRWRD SSDC 2016, DETAIL NOS. RWRD 211, 212, 304 OR 305 (AS APPLICABLE). THE CONTRACTOR SHALL PROTECT THE BENCH AND FLOW CHANNELS WITH A COVER PER PCRWRD SSDC 2016, DETAIL NO. RWRD 306. PRIOR TO COMMENCING ANY WORK TO THE MANHOLE AND REMOVE THE COVER AFTER ALL WORK IS COMPLETED. THE CONTRACTOR SHALL ENSURE THAT FRAMES AND COVERS ARE CLEAN AND FREE FROM ANY AND ALL ATTACHED MATERIALS (ASPHALT, CONCRETE, ETC.) AND THAT ALL VENT HOLES ARE OPEN AND CLEAR OF OBSTRUCTIONS, AS APPROVED BY THE PCRWRD FIELD ENGINEER. EXISTING FRAMES AND COVERS THAT ARE DAMAGED OR CANNOT BE COMPLETELY CLEANED SHALL BE REPLACED WITH A NEW FRAME AND COVER IN ACCORDANCE WITH PCRWRD SSDC 2016, DETAIL NO. RWRD 213 - 218. COSTS ASSOCIATED WITH EXISTING FRAMES AND COVERS THAT ARE LOST OR DAMAGED DUE TO THE CONTRACTOR'S OPERATIONS SHALL BE THE RESPONSIBILITY OF THE CONTRACTOR.
- THE CONTRACTOR SHALL SUBMIT A FLOW MANAGEMENT PLAN (FMP) TO PCRWRD FIELD ENGINEERING FOR APPROVAL BEFORE PROCEEDING WITH ANY WORK THAT MAY AFFECT LIVE SEWERS. THE FMP SHALL IDENTIFY AND INCLUDE ALL FLOW MANAGEMENT COSTS IN THE CONSTRUCTION BID. THE FMP SHALL BE SUBMITTED THIRTY (30) CALENDAR DAYS PRIOR TO THE SEWER PRE-CONSTRUCTION MEETING. FIELD ENGINEERING WILL REVIEW THE FMP WITHIN TEN (10) BUSINESS DAYS TO ACCOMMODATE REVIEW AND REVISION CYCLES. REFER TO PCRWRD SSDC 2016, SECTION 2 FOR FMP REQUIREMENTS. PLEASE CONTACT PCRWRD FIELD ENGINEERING AT (520) 724-2651 FOR ANY QUESTIONS REGARDING FLOW MANAGEMENT.
- STORM WATER AND SEDIMENT CONTROL MEASURES SHALL BE PROPERLY INSTALLED TO PROTECT PCRWRD MANHOLES AT THE BEGINNING OF CONSTRUCTION. IT IS THE RESPONSIBILITY OF THE CONTRACTOR TO CONSTANTLY MAINTAIN STORM WATER AND SEDIMENT CONTROL MEASURES THAT PROTECT PCRWRD FACILITIES UNDER ALL CONDITIONS FOR THE DURATION OF THE PROJECT. UNDER NO CIRCUMSTANCES SHALL THE CONTRACTOR ALLOW STORM WATER, SEDIMENT, OR POTENTIAL POLLUTANTS FROM A CONSTRUCTION SITE TO ENTER A PCRWRD MANHOLE. THE CONTRACTOR SHALL ENSURE THAT THEIR FLOW MANAGEMENT OPERATIONS INCLUDE CONTROLS TO PREVENT ANY INTRODUCTION OF STORM WATER, SEDIMENT, OR POLLUTANTS INTO THE PUBLIC SANITARY SEWER SYSTEM. FAILURE TO CONFORM TO THESE REQUIREMENTS SHALL RESULT IN CANCELLATION OF THE SEWER CONSTRUCTION PERMIT.
- PRIOR TO THE PRECONSTRUCTION MEETING WITH PCRWRD, THE CONTRACTOR SHALL IDENTIFY ALL EXISTING SANITARY SEWER MANHOLE COVERS HAVING FOREIGN MATERIALS ATTACHED. FOREIGN MATERIALS SHALL BE REMOVED FROM THE EXISTING MANHOLE COVERS REGARDLESS OF EXISTING OR NEW CONDITIONS. IF BUILD-UP IS TOO HEAVY TO BE REMOVED, THE CONTRACTOR SHALL REPLACE THE MANHOLE FRAME AND COVER AND SALVAGED ITEMS SHALL BE DELIVERED TO PIMA COUNTY CONVEYANCE AT 3355 N. DODGE BLVD., TUCSON, AZ. THE CONTRACTOR SHALL COORDINATE WITH THE PCRWRD INSPECTOR TO SCHEDULE A TIME TO DELIVER THE SALVAGED FRAMES AND COVERS. AFTER THE COMPLETION OF PAVEMENT WORK, THE CONTRACTOR SHALL VERIFY THAT ALL SANITARY SEWER MANHOLE COVERS AND PICK HOLES ARE CLEAN AND FREE OF ANY CONSTRUCTION MATERIALS, DEBRIS, AND/OR OBSTRUCTIONS.
- ANY WORK INSIDE OR AROUND AN EXISTING SANITARY SEWER MANHOLE, INCLUDING MANHOLES THAT ARE LOCATED WITHIN THE ROUGH GRADING LIMITS FOR A PROJECT, SHALL BE PROTECTED FROM FALLING DEBRIS BY INSTALLING A TEMPORARY FLOW CHANNEL COVER PER PCRWRD STANDARD SPECIFICATIONS AND DETAILS FOR CONSTRUCTION, STANDARD DETAIL RWRD-306. THE CONTRACTOR SHALL REMOVE ANY DEBRIS THAT ENTERS A MANHOLE DURING CONSTRUCTION. FAILURE BY THE CONTRACTOR TO PROMPTLY REMOVE DEBRIS FROM A MANHOLE SHALL RESULT IN PCRWRD TAKING CORRECTIVE ACTION THAT WILL THEN BE BILLED TO THE CONTRACTOR.
- PRIOR TO COMMENCING WITH MANHOLE ADJUSTMENT WORK (I.E., REMOVAL OF THE MANHOLE FRAME AND COVER), THE CONTRACTOR SHALL VISUALLY INSPECT THE CONDITION OF THE MANHOLE FRAME, COVER, AND GRADE RINGS TO IDENTIFY ANY SPECIAL COATINGS, LININGS OR OTHER CONDITIONS THAT MAY REQUIRE ADDITIONAL WORK AND INSPECTION BY PCRWRD. IF SUCH CONDITIONS ARE IDENTIFIED, THE CONTRACTOR SHALL IMMEDIATELY NOTIFY FIELD ENGINEERING AT (520) 724-2651 FOR FURTHER DIRECTION.

PUBLIC IMPROVEMENTS FOR THE HUB AT TUCSON PHASE III
SECTION 7, T-14S, R-14E, G&SRM, PIMA COUNTY, ARIZONA
T18PI00006

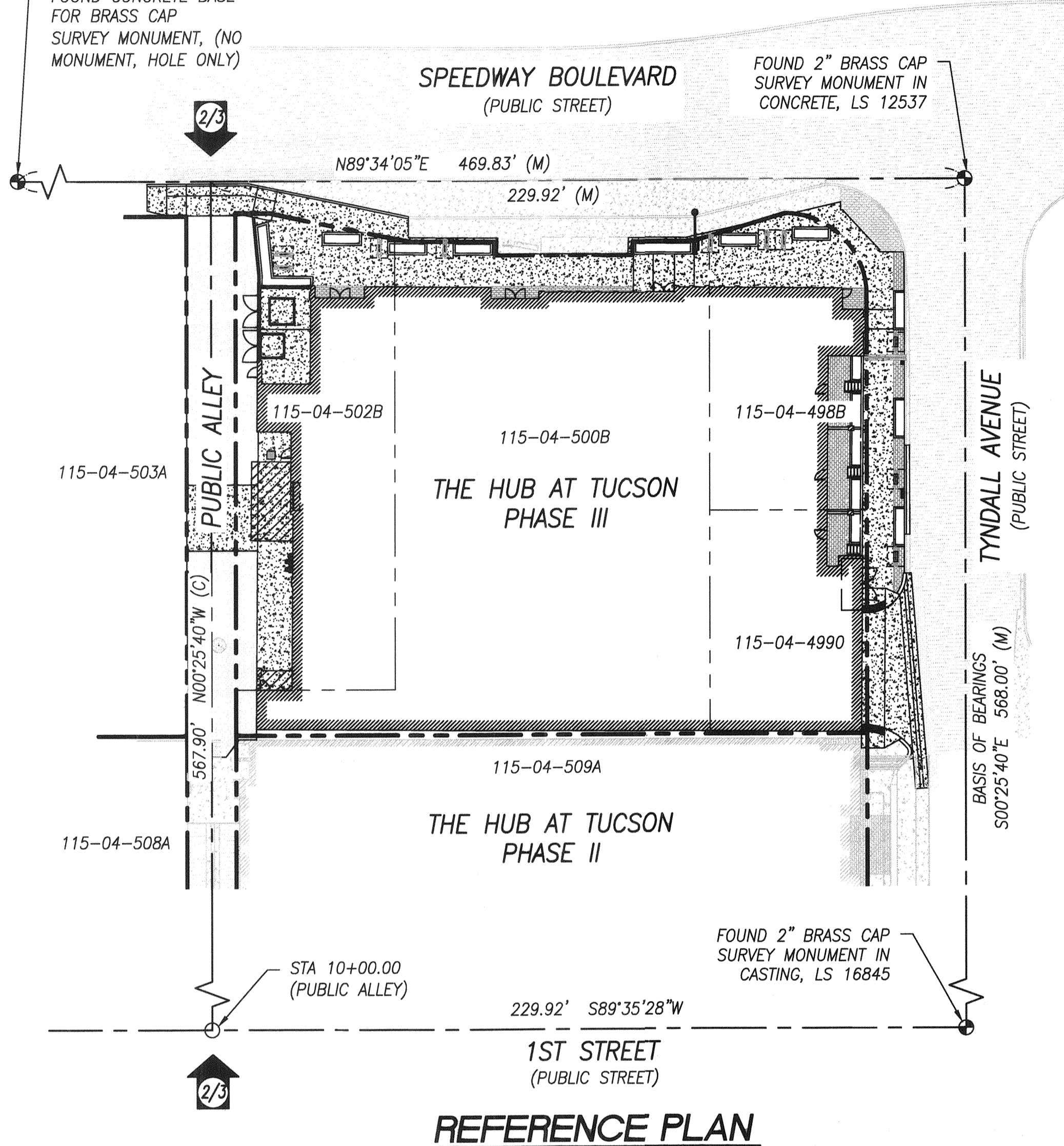

REFERENCE PLAN

ABBREVIATIONS

ABC	AGGREGATE BASE COURSE
AC	ASPHALTIC CONCRETE
C	CALCULATED
E	EAST
EA	EACH
EX	EXISTING
FL	FLOW LINE
LT	LEFT
M	MEASURED
M&P	MAPS & PLATS
MAX	MAXIMUM
ME	MATCH EXISTING
N	NORTH
NE	NORTHEAST
NO	NUMBER
NW	NORTHWEST
OC	ON CENTER
P	PAVEMENT
PC/COT	PIMA COUNTY/ CITY OF TUCSON
R	RANGE
ROW	RIGHT OF WAY
RT	RIGHT
S	SECTION, SOUTH
SE	SOUTHEAST
STA	STATION
STD	STANDARD
SW	SOUTHWEST
T	TOWNSHIP
TEP	TUCSON ELECTRIC POWER
UNO	UNLESS NOTED OTHERWISE
W	WEST

CIVIL ENGINEER

GRENIER ENGINEERING, INC.
CONTACT : JASON MORSE, P.E.
ADDRESS : 6300 E. EL DORADO PLAZA SUITE A120, TUCSON, AZ 85715
PHONE : (520) 326-7082
FAX : (520) 326-7508
EMAIL : jmorse@greniereng.com

OWNER/DEVELOPER

CORE SPACES
CONTACT : ERIC GRIMM
ADDRESS : 1634 N. MILWAUKEE AVENUE CHICAGO, IL 60647
PHONE : (773) 969-5740
EMAIL : ericg@corespaces.com

BASIS OF ELEVATIONS

THE BASIS OF ELEVATIONS FOR THIS PROJECT IS THE CITY OF TUCSON (COT) BENCHMARK No. 128, BEING A CHISELED "X" ON THE SOUTHEAST CORNER OF THE CONCRETE SIGNAL LIGHT BASE AT THE NORTHEAST CORNER OF SPEEDWAY BOULEVARD AND DENZA AVENUE. SAID ELEVATION BEING 2430.34 (NAVD-88) PER COT FIELD BOOK 1989-X, PAGE 9.

BASIS OF BEARINGS

THE BASIS OF BEARINGS FOR THIS PROJECT IS THE MONUMENT LINE OF TYNDALL AVENUE, FROM SPEEDWAY BOULEVARD TO FIRST STREET. SAID BEARING BEING SOUTH 00°25'40" EAST, AS SHOWN HEREON.

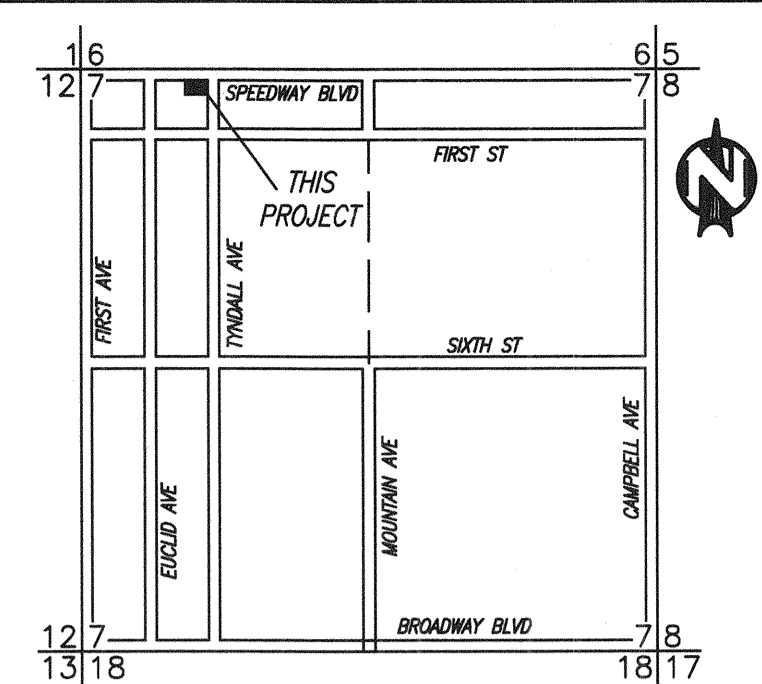

LOCATION MAP

SCALE: 3" = 1 MILE
A PORTION OF THE SECTION 7, T-14-S, R-14-E GILA AND SALT RIVER MERIDIAN, PIMA COUNTY, ARIZONA

ADMINISTRATIVE ADDRESS

850 E. SPEEDWAY BLVD.
TUCSON, AZ 85719

SHEET INDEX

SHEET 1	COVER & NOTES
SHEET 2	DEMOLITION PLAN & SIGNING PLAN
SHEET 3	PLAN & PROFILE
SHEET 4	SECTIONS & DETAILS

LEGEND

FEATURE	NEW	EXISTING
SURVEY MONUMENT		
BOUNDARY LINE		
MONUMENT LINE		
CONTOUR LINE - MAJOR	--- 50 ---	--- 50 ---
CONTOUR LINE - MINOR	----- 51 -----	----- 51 -----
A.C. PAVEMENT		
CONCRETE CURB		
CONCRETE CURB & GUTTER		
CONCRETE SIDEWALK/PAD		
BUILDING EXTERIOR WALL		
WALL		
OVERHEAD UTILITY LINE		
GUY WIRE		
POWER POLE		
LIGHT POLE		
GAS METER		
SANITARY SEWER LINE	— S —	— S —
SANITARY SEWER MANHOLE		
WATER METER		
BACKFLOW PREVENTOR		
SLOPE ARROW	← 51.00	← 51.00
GRADE POINT		
SIGN		
FENCE		

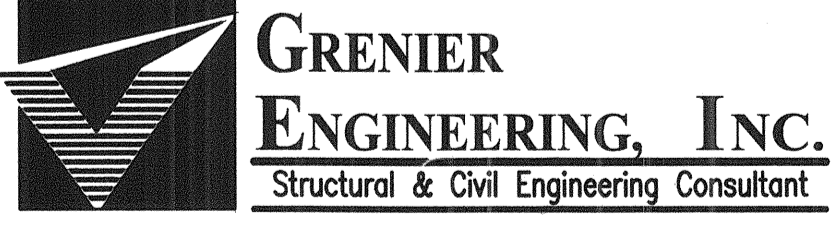
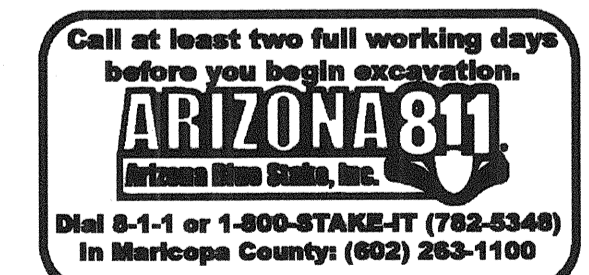

6300 E. El Dorado Plaza Suite A120, Tucson, Arizona 85715
Phone: 520.326.7082 ~ Fax: 520.326.7508

DEPARTMENT OF TRANSPORTATION/ENGINEERING DIVISION

PUBLIC IMPROVEMENTS THE HUB AT TUCSON PHASE III

Approvals	Signature	Date	Approved	20__	1
PERMITS AND CODES SECTION	<i>[Signature]</i>	12/18			OF
TRAFFIC ENGINEERING	<i>[Signature]</i>	11/18			4
STREETS AND TRAFFIC MAINTENANCE	<i>[Signature]</i>	11/18			
ENGINEERING ADMINISTRATOR	<i>[Signature]</i>	12/19			
DRWN. BY	AR	2018	DSGN. BY	AR/JM	2018
CHKD. BY	JM	2018	PLAN NO.	U-2018-003	

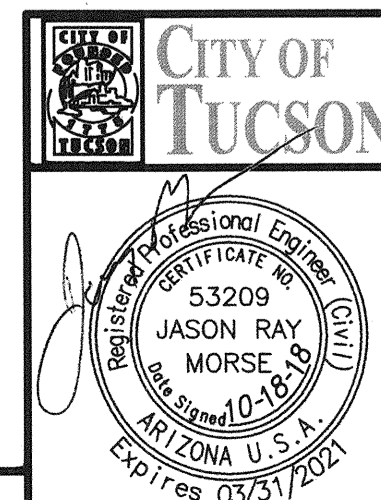

NO.	DATE	REVISION	BY	CHKD.	APPR.
-----	------	----------	----	-------	-------

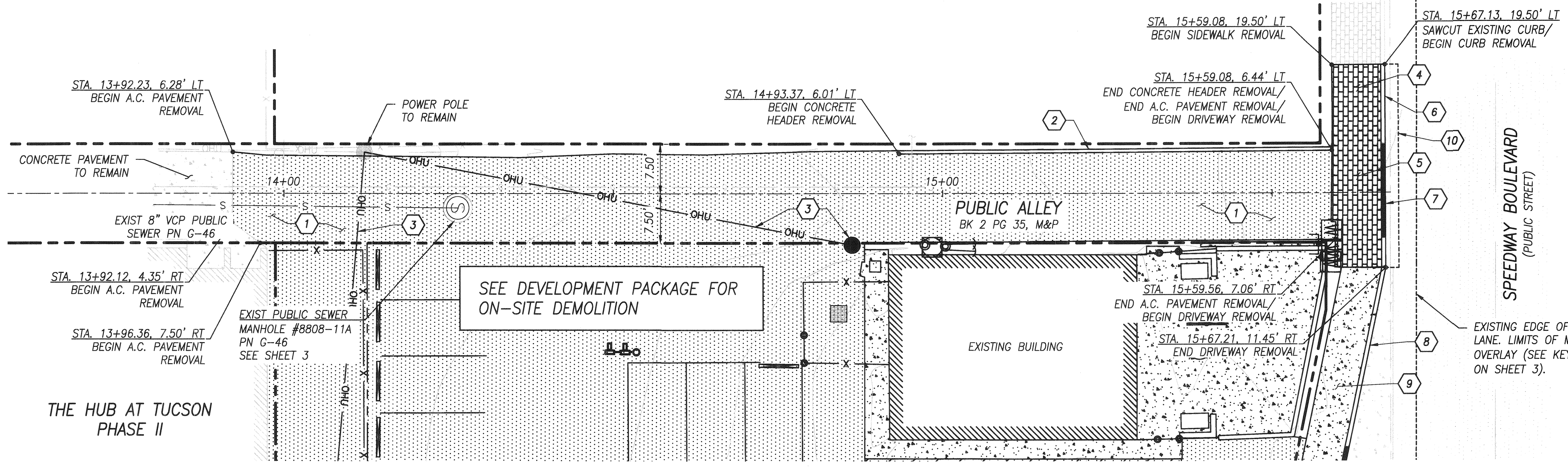
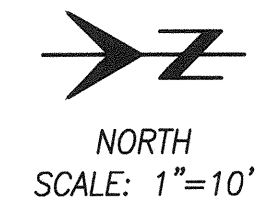

PUBLIC ALLEY DEMOLITION PLAN

STATIONING IS ALONG ALLEY CENTER LINE
SCALE: 1"=10' HORIZONTAL

DEMOLITION KEYNOTES

- 1 EXISTING A.C. PAVEMENT TO BE REMOVED.
- 2 EXISTING CONCRETE HEADER TO BE REMOVED.
- 3 EXISTING OVERHEAD ELECTRIC AND POWER POLES TO BE RELOCATED BY T.E.P.
- 4 EXISTING SIDEWALK (PAVERS) TO BE REMOVED.
- 5 EXISTING DRIVEWAY (PAVERS) TO BE REMOVED.
- 6 EXISTING CONCRETE VERTICAL CURB TO BE REMOVED.
- 7 EXISTING DEPRESSED CURB TO BE REMOVED.
- 8 EXISTING CURB TO BE REMOVED AND REPLACED SEE DEVELOPMENT PACKAGE (DP17-0301).
- 9 EXISTING SIDEWALK TO BE REMOVED AND REPLACED SEE DEVELOPMENT PACKAGE (DP17-0301).
- 10 SAWCUT EXISTING PAVEMENT 2' FROM FACE OF CURB.

SIGNING GENERAL NOTES

- 1. ALL SIGNS SHALL BE IN COMPLIANCE WITH THE 2009 EDITION OF THE MANUAL ON UNIFORM TRAFFIC CONTROL DEVICES, 2002 EDITION OF THE PIMA COUNTY AND CITY OF TUCSON TRAFFIC SIGNING DESIGN MANUAL, THE CURRENT SUPPLEMENTAL SPECIFICATIONS, THESE PLANS, AND THE SPECIAL PROVISIONS.
- 2. SIGNS MAY BE MODIFIED AND LOCATIONS ADJUSTED TO FIT CONDITIONS AS DIRECTED BY THE TRAFFIC ENGINEER.
- 3. POST LENGTHS INDICATED ON SIGN SUMMARY SHEETS ARE APPROXIMATE. THE CONTRACTOR SHALL VERIFY ACTUAL POST LENGTHS.
- 4. ALL PERFORATED POSTS SHALL BE INSTALLED IN A CONCRETE FOUNDATION, UNLESS OTHERWISE DIRECTED BY THE JURISDICTION TRAFFIC ENGINEER. (STANDARD 8-2A)
- 5. ALL SIGN STATION LOCATIONS ARE APPROXIMATE. THE CONTRACTOR SHALL VERIFY ACTUAL SIGN LOCATIONS WITH THE TRAFFIC ENGINEER PRIOR TO THE INSTALLATION OF ALL SIGNS. THE CONTRACTOR SHALL BE RESPONSIBLE FOR COORDINATING ALL WORK WITH BLUE STAKE AND FOR INSTALLING ALL TRAFFIC SIGNS IN THE FIELD.
- 6. ON CITY OF TUCSON PROJECTS, ALL WARNING SIGN PANELS SHALL BE FLUORESCENT YELLOW DIAMOND GRADE (DG3/ASTM TYPE XI) SHEETING. ALL SCHOOL ZONE SIGNS SHALL BE FLUORESCENT YELLOW-GREEN DIAMOND GRADE (DG3/ASTM TYPE XI) SHEETING. ALL OTHER SIGN PANELS SHALL HAVE HIGH INTENSITY PRISMATIC TYPE IV SHEETING. ALL SHEETING USED FOR REGULATORY AND WARNING SIGNS SHALL BE COVERED WITH A PROTECTIVE OR ANTI-GRAFFITI FILM FROM THE SAME MANUFACTURE AND APPLIED BY THE MANUFACTURERS RECOMMENDATIONS.
- 7. ALL NEW SIGNS SHALL HAVE STRAIGHT AND TRUE ALUMINUM BACKING, UNLESS OTHERWISE SPECIFIED.
- 8. ALL EXISTING SIGNS TO BE REMOVED AS PART OF THIS PROJECT ARE TO BE DELIVERED TO THE CITY OF TUCSON SIGN SHOP AT 4004 S. PARK (791-3154). THE CONTRACTOR IS RESPONSIBLE FOR UNLOADING THE SALVAGED MATERIAL. ANY SALVAGED SIGN THAT IS APPROVED TO BE REUSED SHALL BE TEMPORARILY STORED IN A SAFE LOCATION UNTIL REINSTALLATION.
- 9. THE SPEED LIMIT FOR THE ALLEY IS 15 MPH. SIGN PLACEMENT SHALL BE BASED ON THE POSTED SPEED LIMIT.

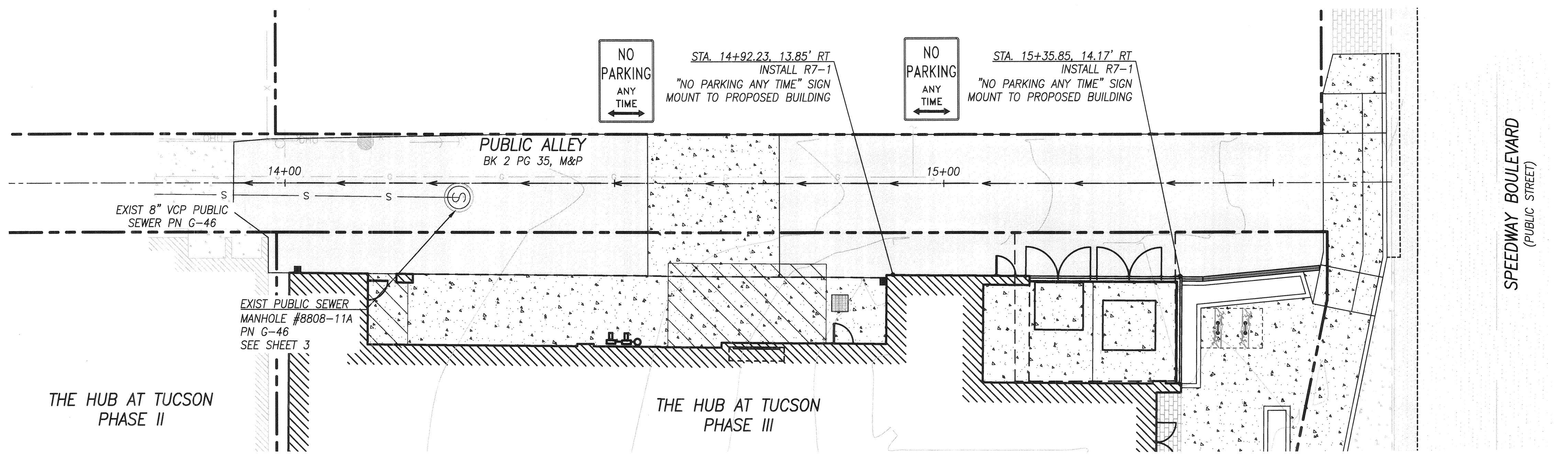
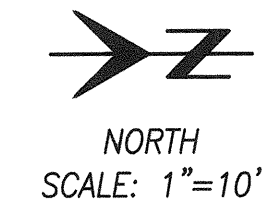

PUBLIC ALLEY SIGNING PLAN

STATIONING IS ALONG ALLEY CENTER LINE
SCALE: 1"=10' HORIZONTAL

SIGNING QUANTITY SUMMARY

ITEM	UNITS	TOTAL QUANTITIES
R7-1 NO PARKING ANY TIME SIGN	EA	2

Call at least two full working days before you begin excavation.
ARIZONA 811
Arizona One Stop, Inc.
Dial 8-1-1 or 1-800-STAKE-IT (782-8348)
In Maricopa County: (602) 263-1100

GRENIER ENGINEERING, INC.
Structural & Civil Engineering Consultant
6300 E. El Dorado Plaza Suite A120, Tucson, Arizona 85715
Phone: 520.326.7082 ~ Fax: 520.326.7508

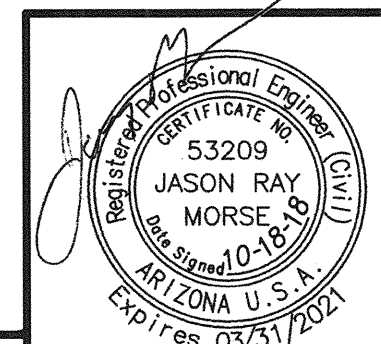

DEPARTMENT OF TRANSPORTATION/ENGINEERING DIVISION		2
PUBLIC IMPROVEMENTS		OF
THE HUB AT TUCSON PHASE III		4
CITY OF TUCSON	DRWN. BY AR	10/18
	DSGN. BY AR/JM	10/18
CHKD. BY JM	10/18	REF. SCALE:
PLAN NO. U-2018-003		

NO.	DATE	REVISION	BY	CHKD.	APPR.

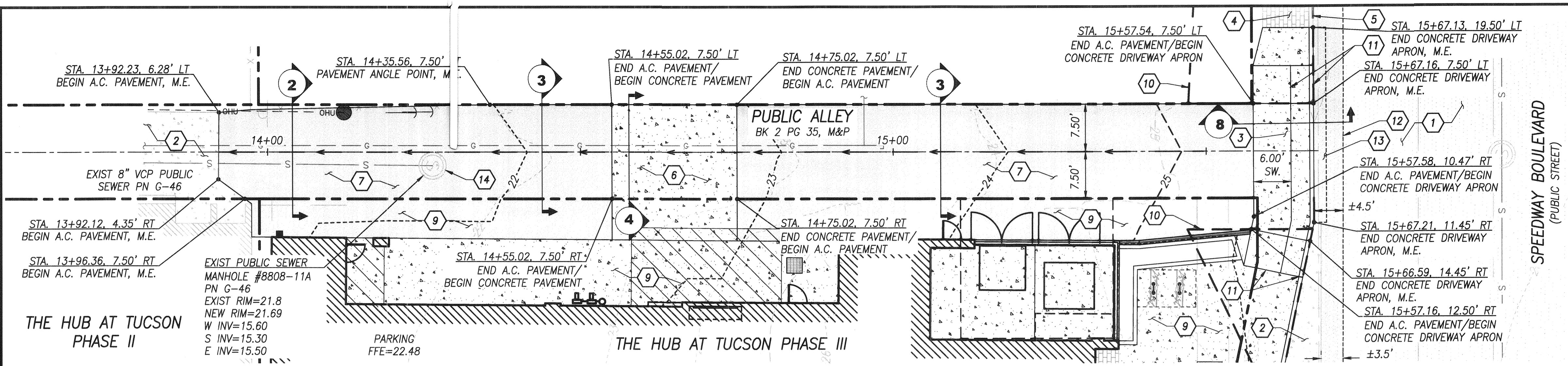
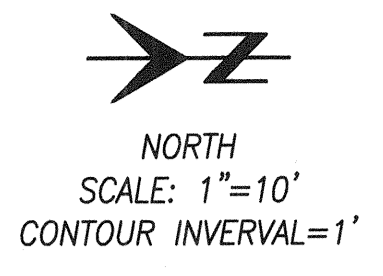

- ### KEYNOTES
- 1 EXISTING A.C. PAVEMENT TO REMAIN.
 - 2 EXISTING CONCRETE PAVEMENT TO REMAIN.
 - 3 NEW CONCRETE DRIVEWAY APRON PER P.A.G. STANDARD DETAIL 206. (SEE IRRIGATION NOTE BELOW)
 - 4 EXISTING SIDEWALK/PAVERS TO REMAIN.
 - 5 EXISTING CONCRETE VERTICAL CURB TO REMAIN.
 - 6 NEW CONCRETE PAVEMENT PER DETAIL 1.
 - 7 NEW A.C. PAVEMENT PER DETAIL 1.
 - 8 NOT USED.
 - 9 ON-SITE IMPROVEMENTS PER ON-SITE DEVELOPMENT PACKAGE.
 - 10 SIGHT VISIBILITY TRIANGLES (NEAR SIDE=345', FAR SIDE=30' (PEDESTRIAN), STEM=20').
 - 11 ACCESSIBLE RAMP AND CONCRETE/CURB/SIDEWALK TRANSITIONS PER P.A.G. STANDARD DETAIL 206. SEE DETAIL 7 FOR GRADES.
 - 12 SAWCUT, TRIM, TACK & JOIN NEW TO EXISTING PAVEMENT.
 - 13 EXISTING BIKE LANE TO BE MILLED AND OVERLAID 50' WEST OF STA.15+67.13, 19.50' LT. AND 50' EAST OF STA.15+67.21, 11.45' RT. RE-STRIPE BIKE LANE TO MATCH EXISTING.
 - 14 EXISTING MANHOLE TO BE ADJUSTED TO NEW FINISHED GRADE PER R.W.R.D. STANDARD DETAIL 305. INSTALL NEW WATER TIGHT FRAME AND COVER PER R.W.R.D. STANDARD DETAIL 214. INSTALL NEW CONCRETE COLLAR PER R.W.R.D. STANDARD DETAIL 211. IF MANHOLE HAS A CORROSION RESISTANT COATING, THAT COATING SHALL BE REPAIRED BY A CERTIFIED APPLICATOR CERTIFIED BY THE MANUFACTURER, AND ALL TESTING ASSOCIATED WITH THE REPAIR.

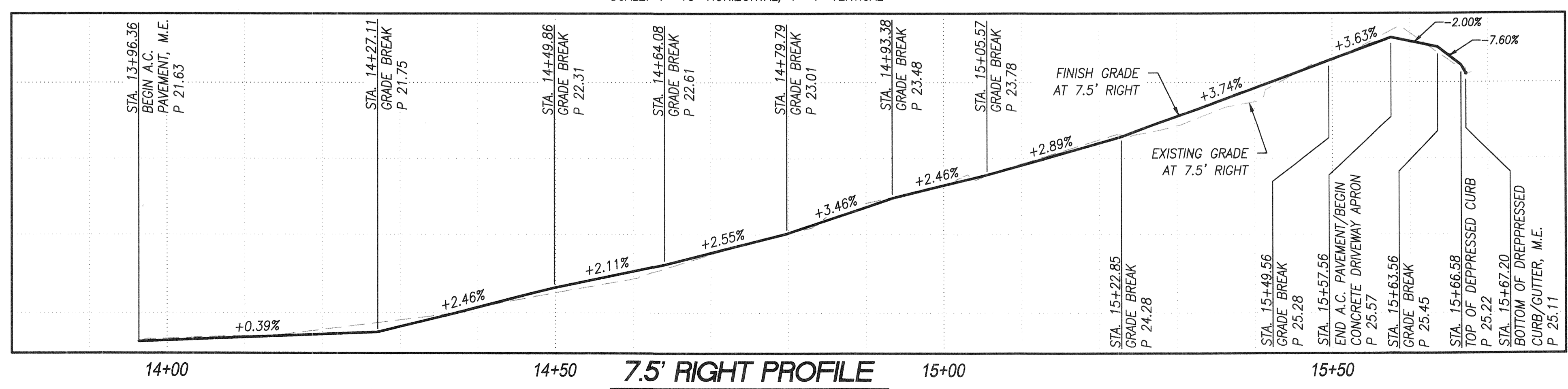
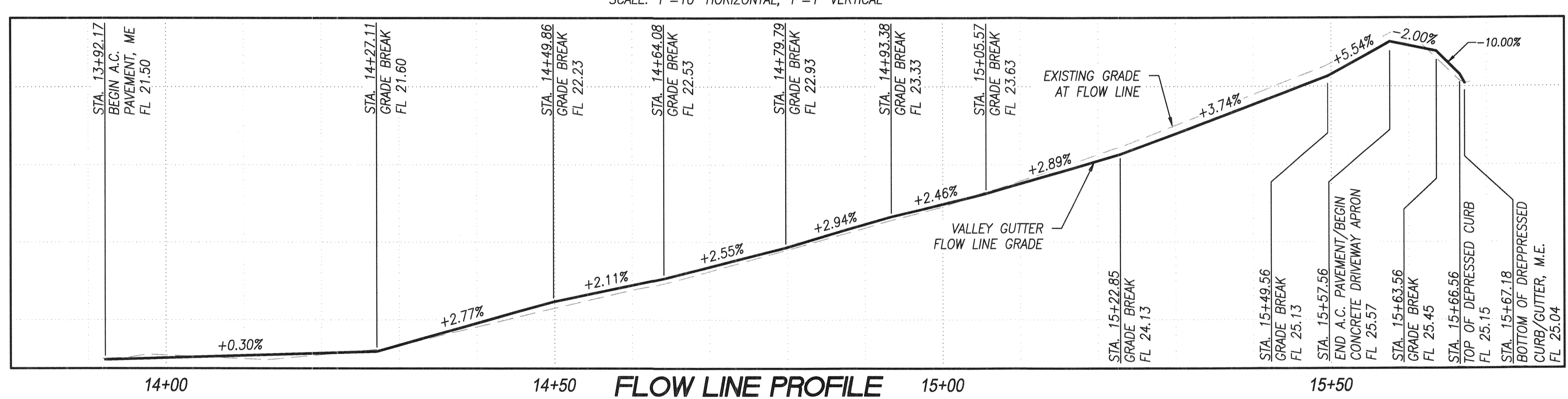
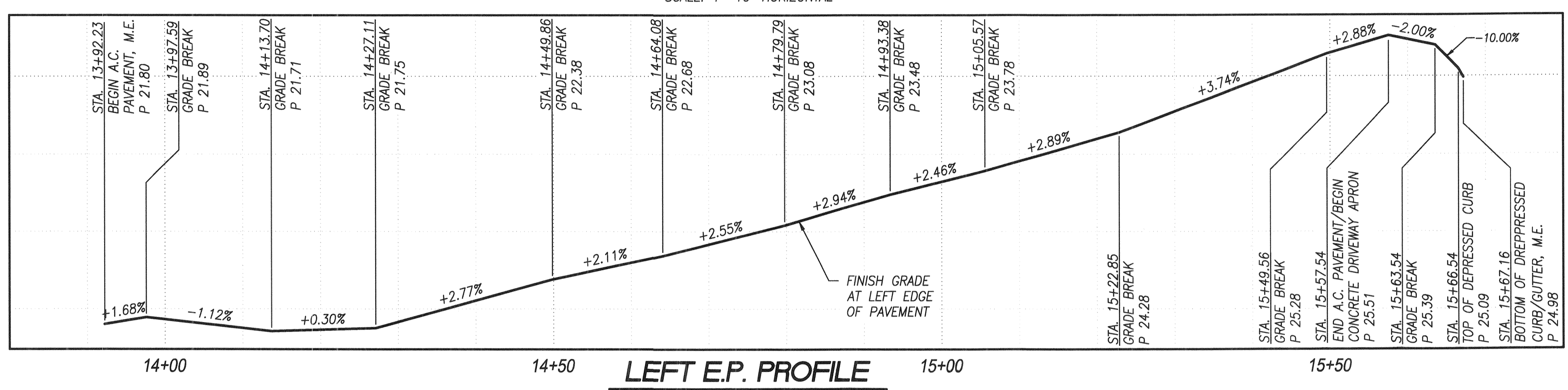

IRRIGATION NOTE
CONTRACTOR TO VERIFY IF ANY EXISTING CITY OWNED IRRIGATION LINES CROSS THE PROPOSED DRIVEWAY APRON. IF SO, THIS LINE(S) SHALL BE SLEEVED UNDERNEATH NEW APRON.

UTILITY NOTE
EXISTING UTILITIES ARE SHOWN BASED ON ABOVE GROUND LOCATION AND UTILITY BASE MAPS. THE LOCATIONS SHOWN HEREON SHOULD BE CONSIDERED APPROXIMATE. THERE MAY BE ADDITIONAL UTILITIES PRESENT WHICH ARE NOT SHOWN ON UTILITY BASE MAPS. THE CONTRACTOR SHALL FIELD LOCATE EXISTING UTILITIES PRIOR TO CONSTRUCTION.

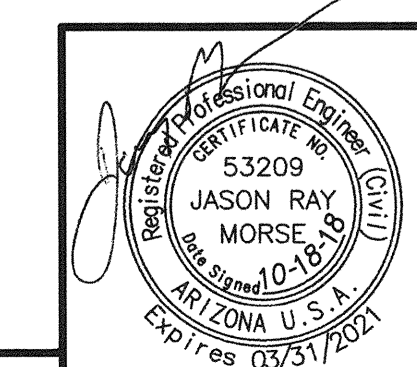
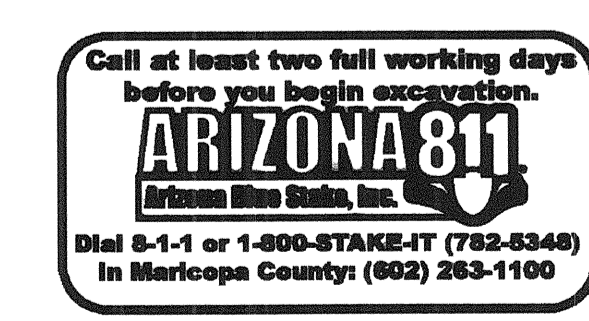

DEPARTMENT OF TRANSPORTATION/ENGINEERING DIVISION		3
PUBLIC IMPROVEMENTS THE HUB AT TUCSON PHASE III		OF
		4
CITY OF TUCSON	DRWN. BY AR	10/18
	DSGN. BY AR/JM	10/18
	CHKD. BY JM	10/18
REF. SCALE:		
PLAN NO.	U-2018-003	

NO.	DATE	REVISION	BY	CHKD.	APPR.

NOTES

1. ALL COURSES ARE TO CONFORM TO RECOMMENDATIONS IN SOILS REPORT.

JOINTS & SCORING PER P.A.G. SPECIFICATIONS. INSTALL REINFORCING (#4 BARS @ 12" O.C. EACH WAY) FOR SLAB LOCATED IN THE PUBLIC ALLEY ONLY.

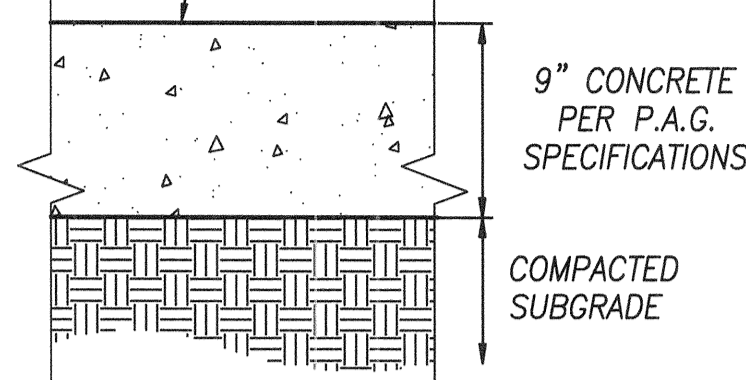
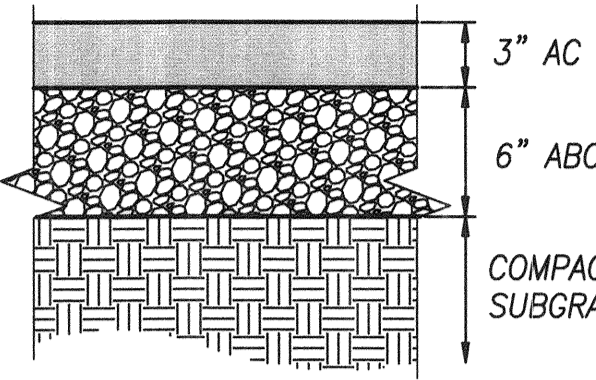

ASPHALT PAVING

CONCRETE PAVING

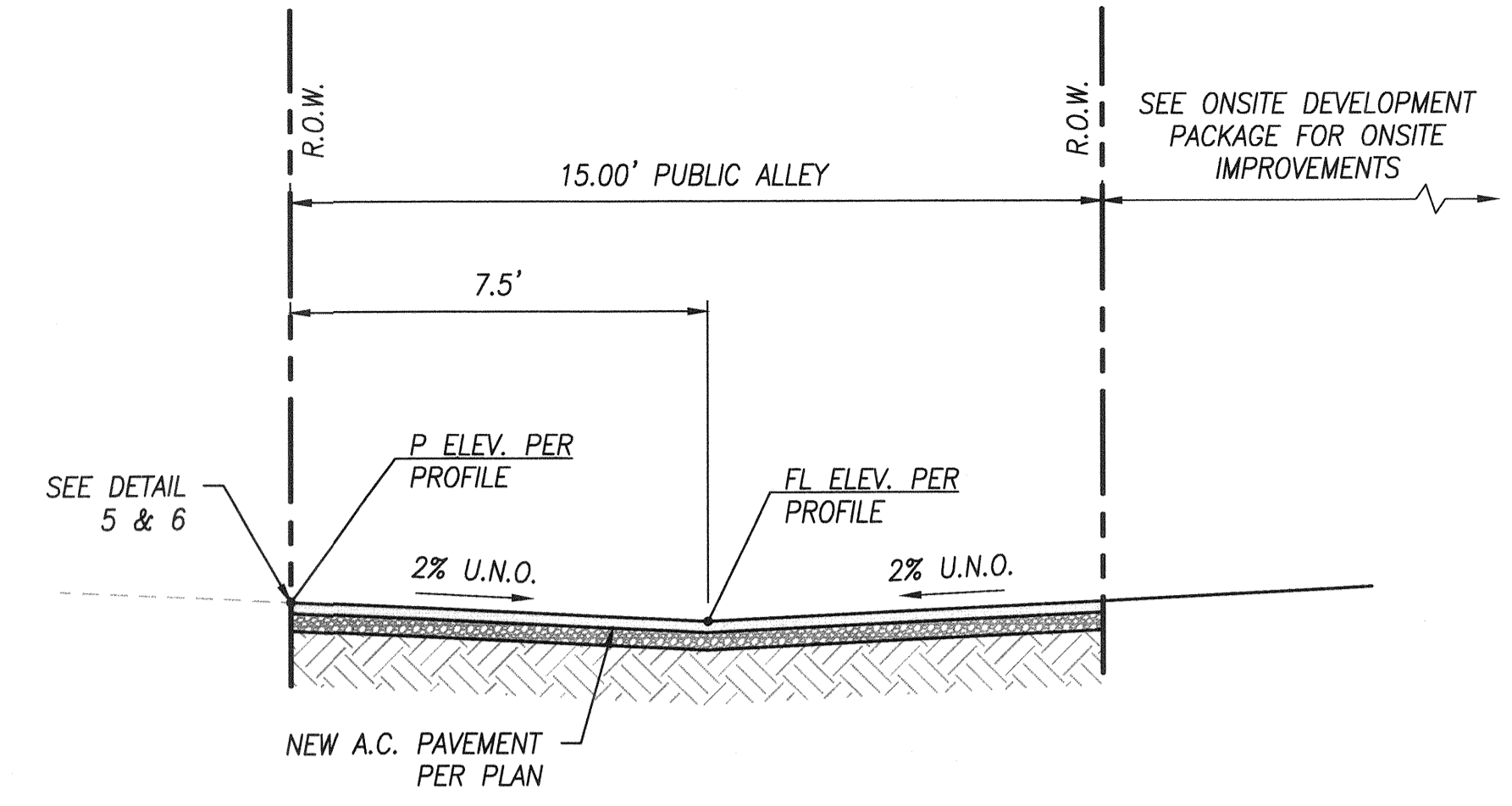
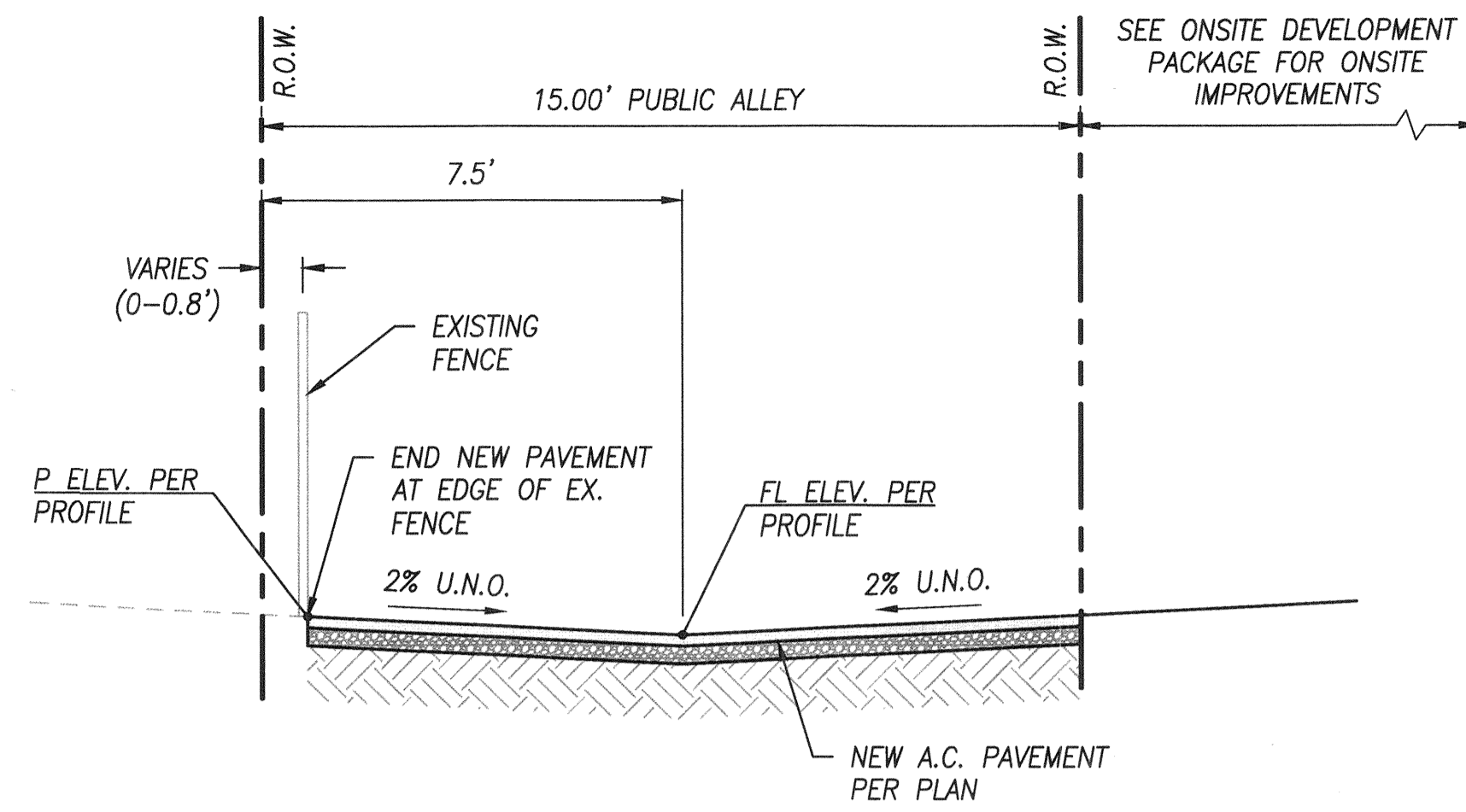

1 HARDSCAPE SECTIONS

N.T.S.

2 SECTION

STA 13+92.17 TO STA 14+35.56

N.T.S.

3 SECTION

STA 14+35.56 TO STA. 14+55.02 & STA 14+75.02 TO 15+49.57

N.T.S.

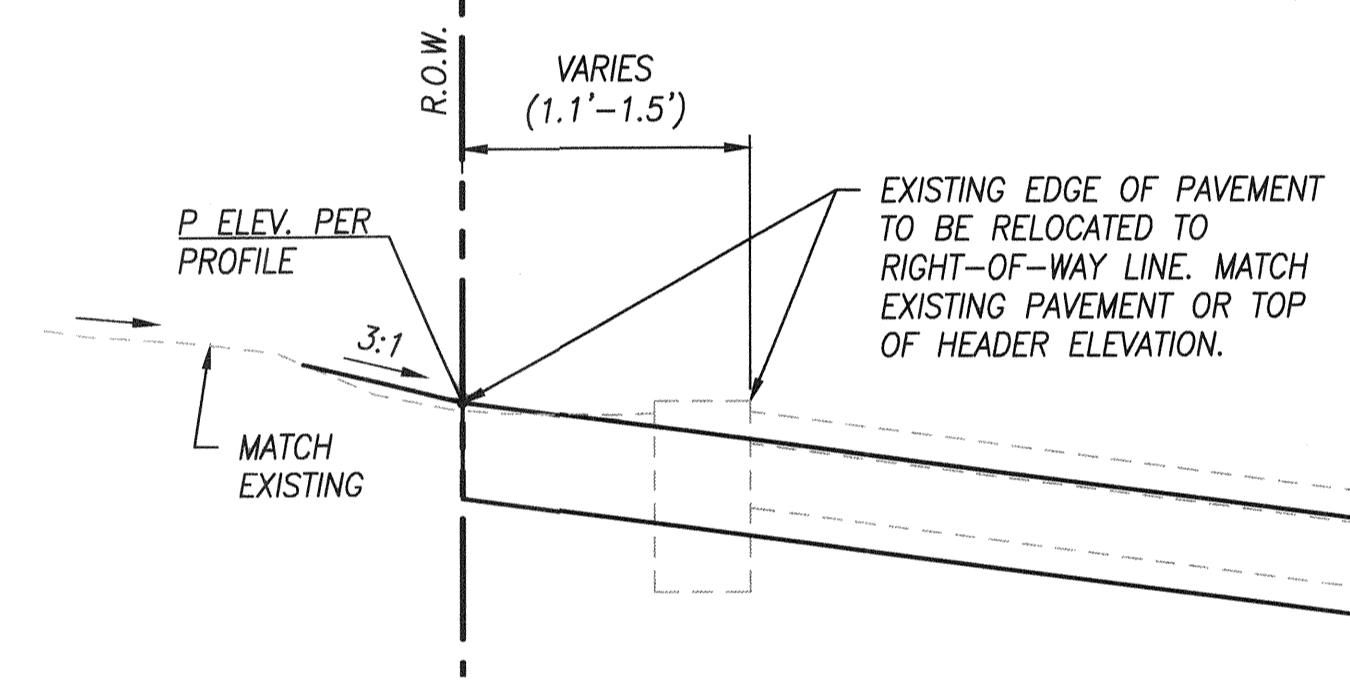
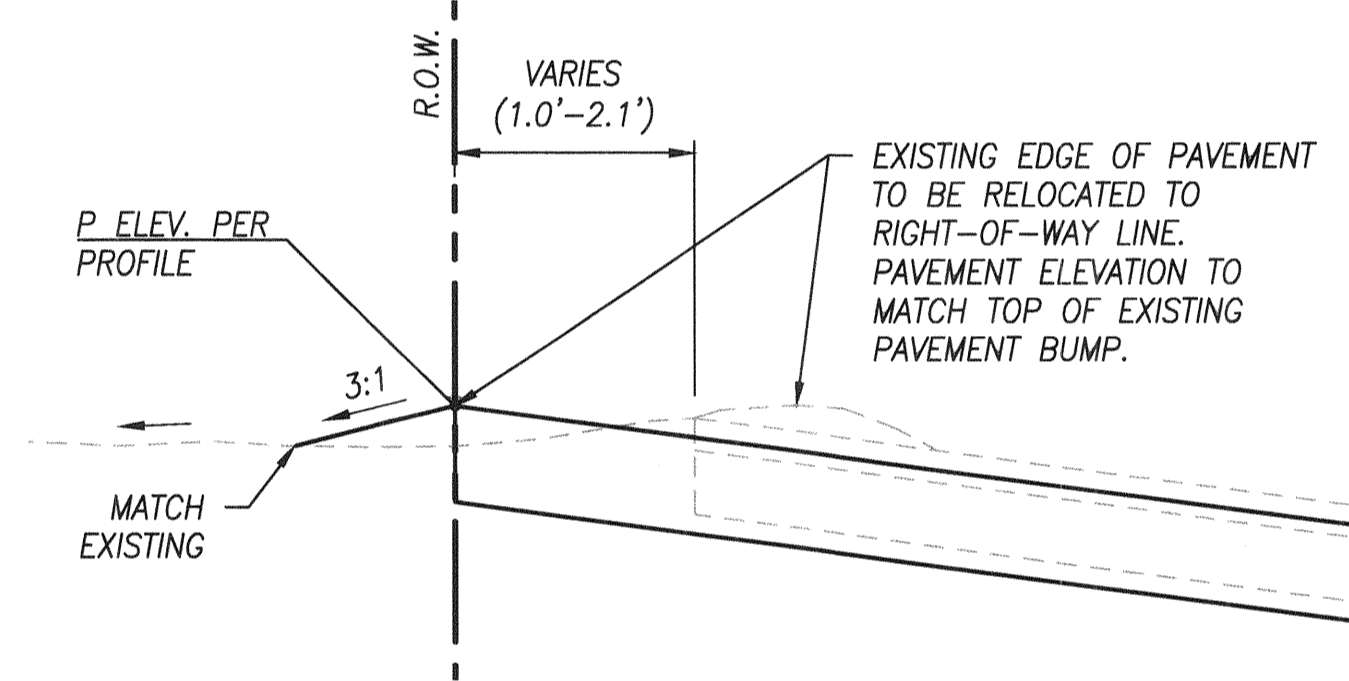
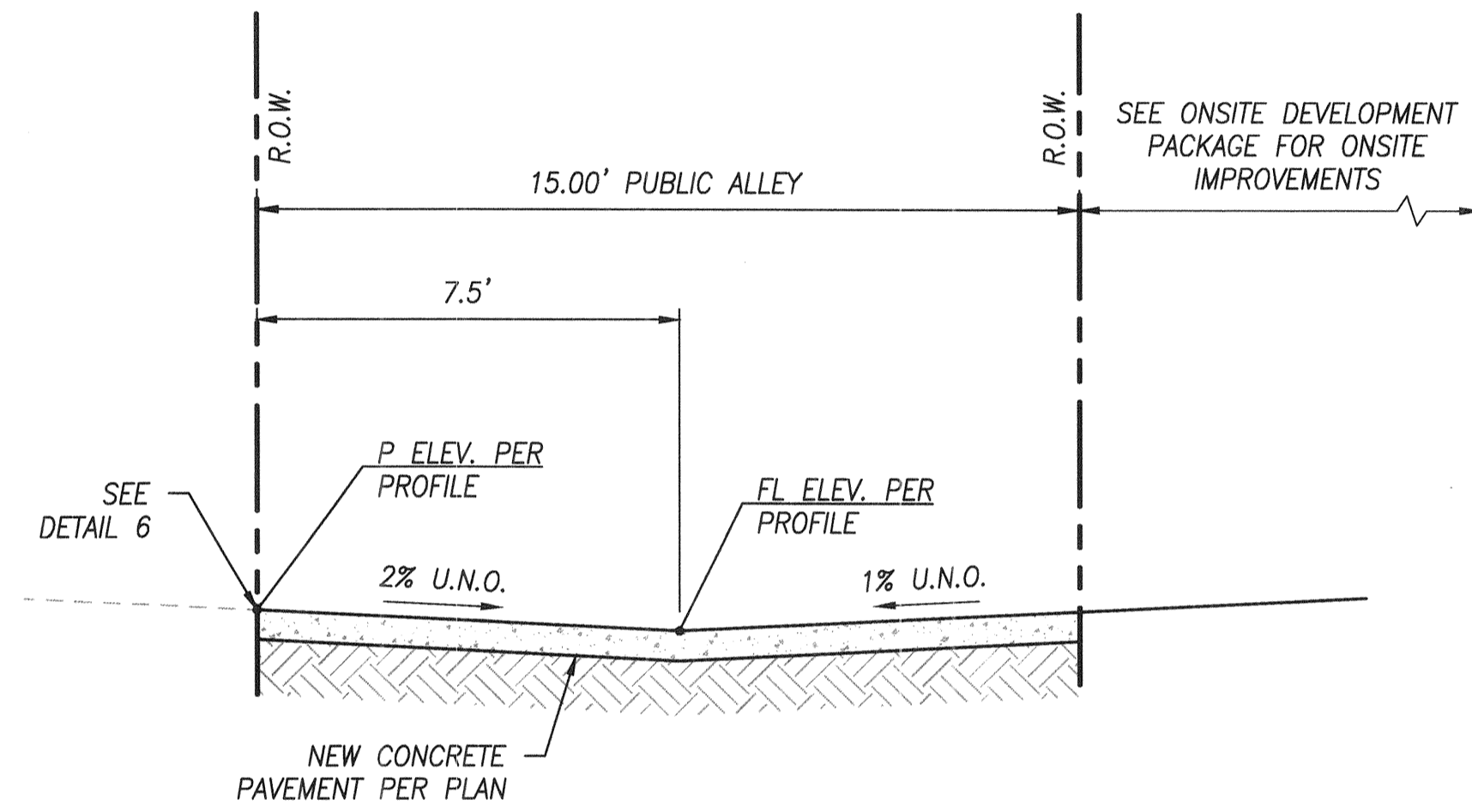

4 SECTION

STA 14+55.02 TO STA. 14+75.02

N.T.S.

5 MATCH EXISTING DETAIL

STA 14+35.56 TO STA 14+93.37

N.T.S.

6 MATCH EXISTING DETAIL

STA 14+93.37 TO STA 15+59.10

N.T.S.

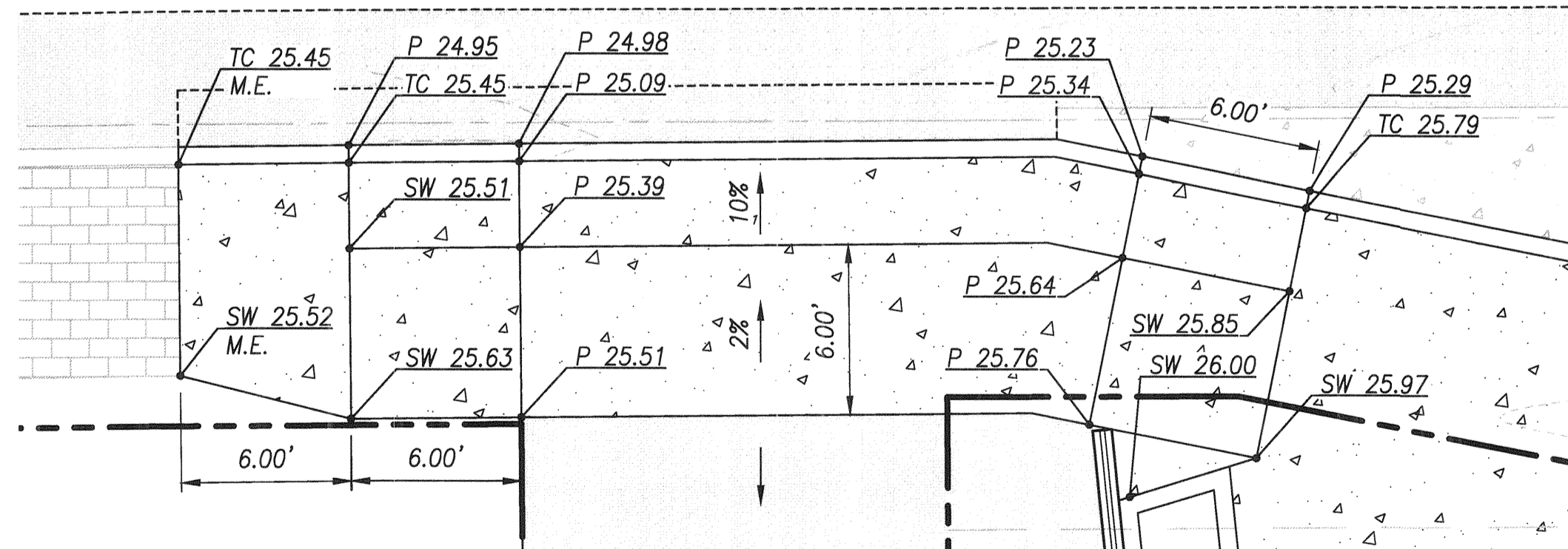

SCALE: 1" = 5'

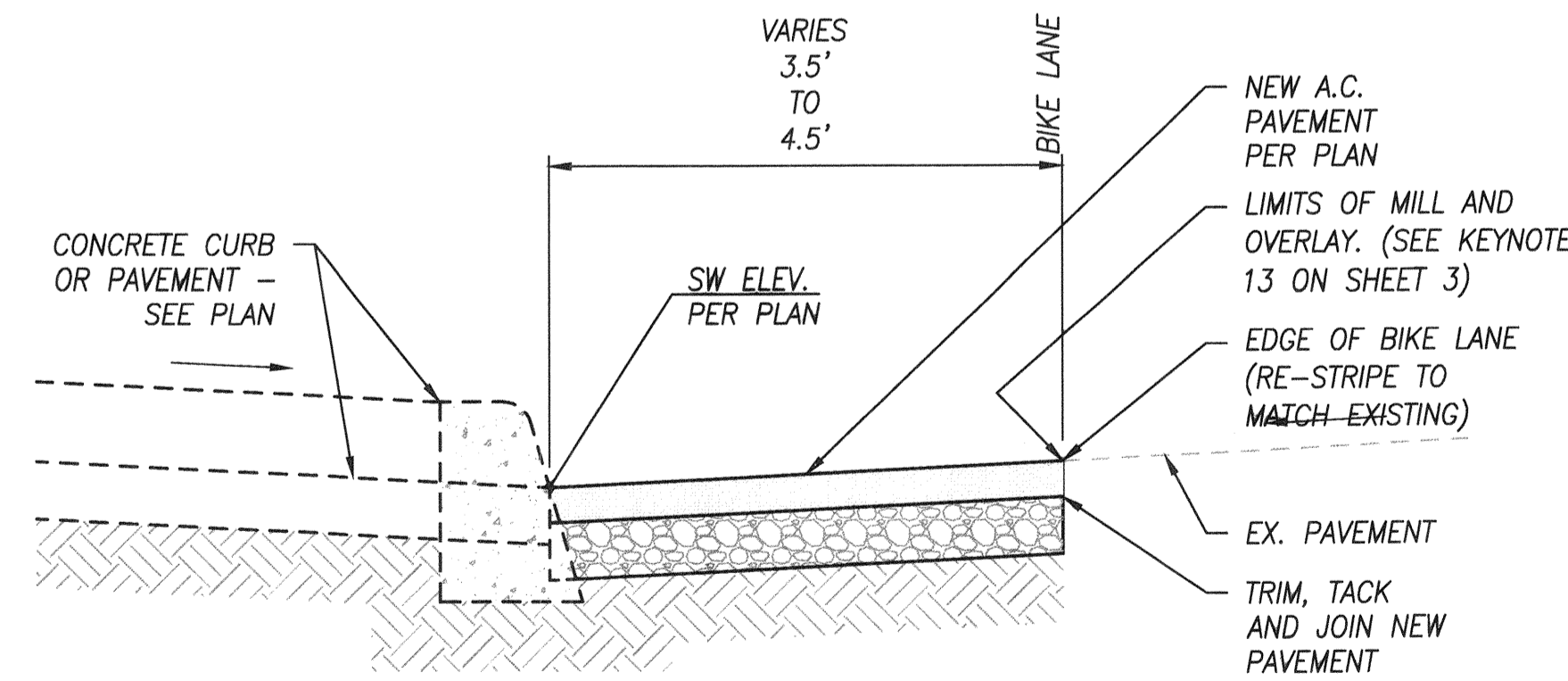

7 DRIVEWAY APRON GRADES

8 SECTION

N.T.S.

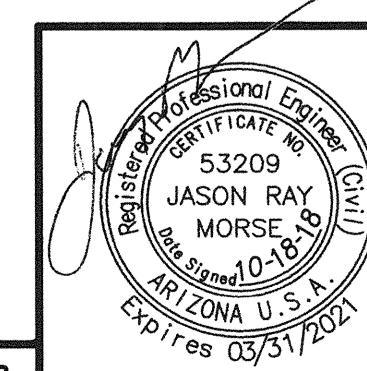
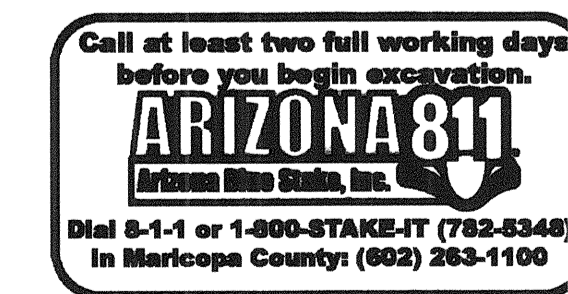

DEPARTMENT OF TRANSPORTATION/ENGINEERING DIVISION				4
PUBLIC IMPROVEMENTS				OF
THE HUB AT TUCSON PHASE III				4
CITY OF TUCSON	DRWN. BY	AR	10/18	REF. SCALE:
	DSGN. BY	AR/JM	10/18	
	CHKD. BY	JM	10/18	
PLAN NO. U-2018-003				

NO.	DATE	REVISION	BY	CHKD.	APPR.
-----	------	----------	----	-------	-------